

2009 Gala Ave
3BR/2BA 1,677 SF

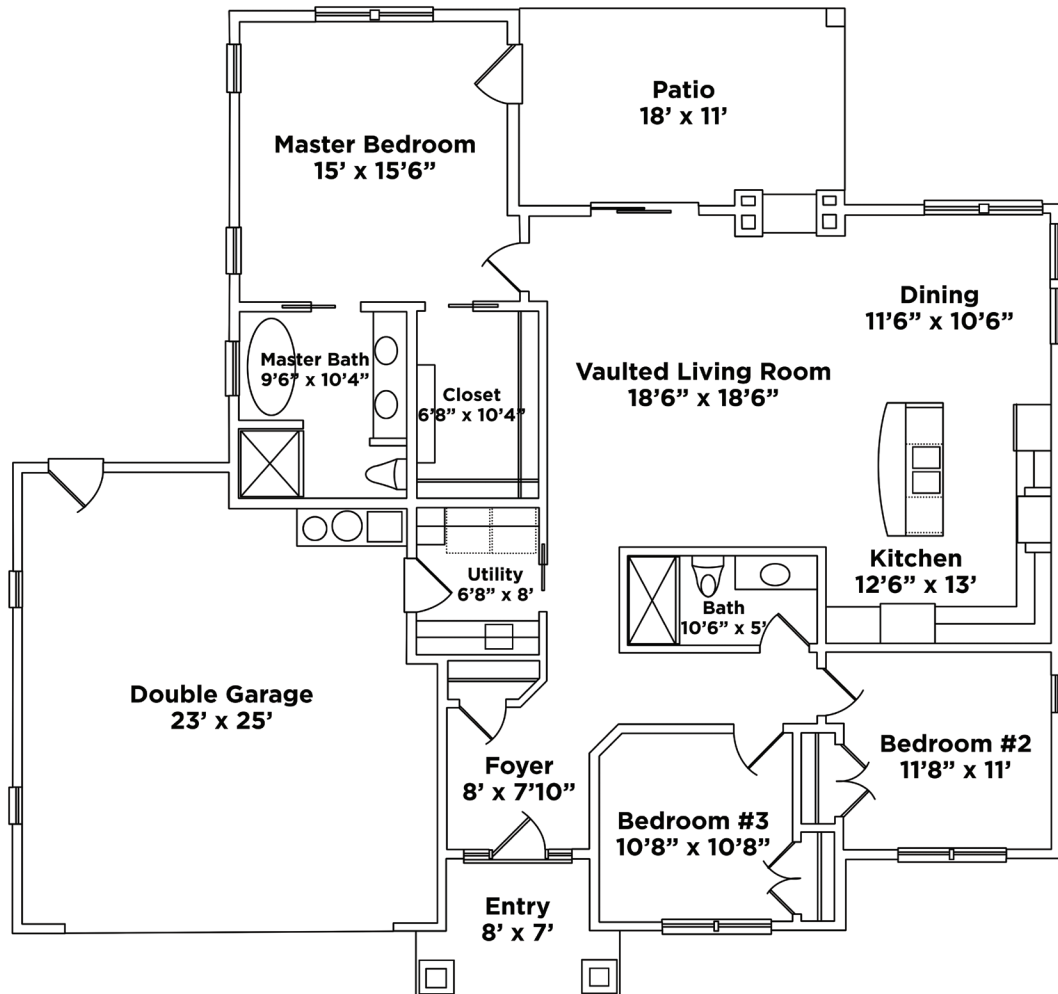

To schedule an appointment or for more information, call
Jon Kinloch at 509.945.3712 or Aaron Hillbery at 509.901.4603

Please Note: The rendering, floor plan, and room measurements on this sales sheet all represent an artistic interpretation of the design used for illustration purposes only. Apple Tree Construction Company, LLC makes no guarantee that the completed home will appear exactly as shown on the rendering as modifications and finish selections often occur during the course of construction.